

70 mm SeaRox FB/FM 6020 or FB/FM 6040
 between stiffeners and
 30 mm SeaRox FB/FM 6050 or
 35 mm SeaRox FB/FM 6040 over the stiffeners

3 mm steel pin
 with washer

Fire side

All measurements in mm

* Dimensions may vary depending on structural design and size of insulation material.



Subject: A-60 Steel Deck:
 Plate: SeaRox FB/FM 6020 or SeaRox FB/FM 6040
 Stiffener: SeaRox FB/FM 6050 or SeaRox FB/FM 6040



TECHNICAL INSULATION

Date: 2021/10/25

Designer: DG

Drawing No. 600-1 / Rev 2

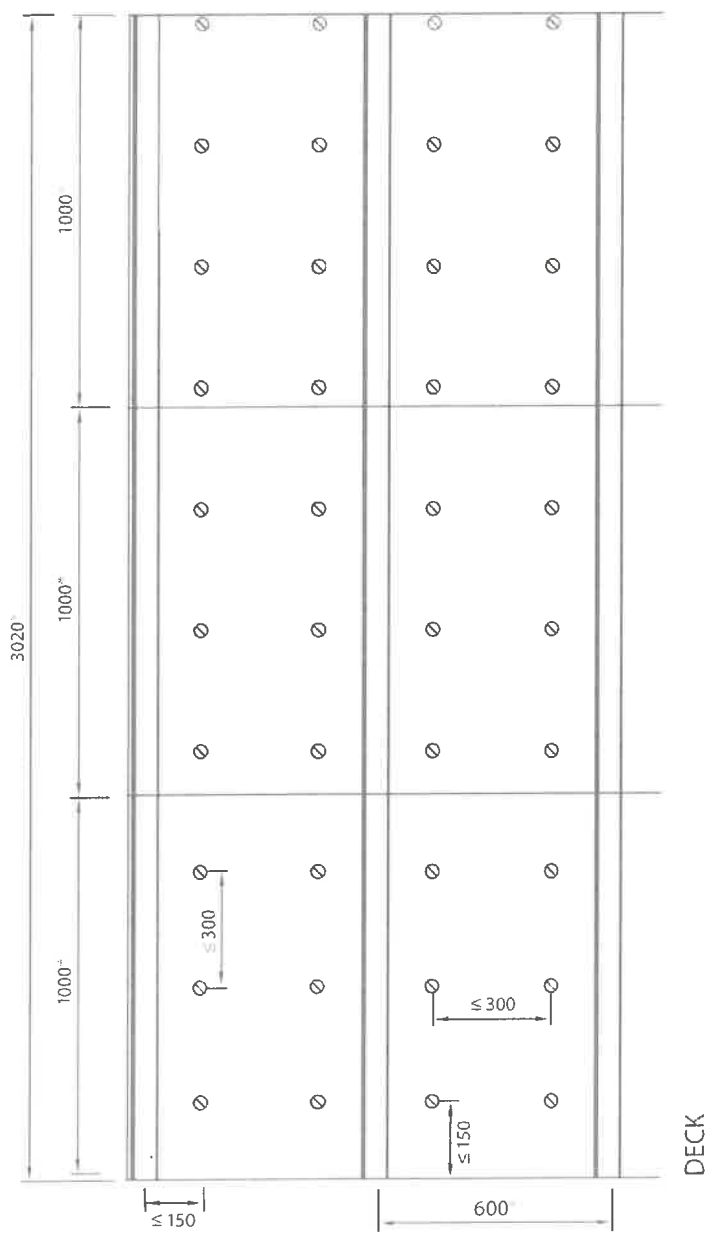

Dimensions may vary depending on structural design and size of insulation material. All measurements in mm

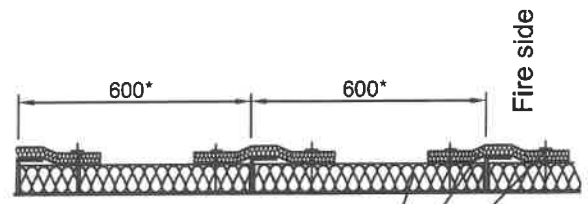

70 mm SeaRox FB/FM 6020 or FB/FM 6040
between stiffeners and
30 mm SeaRox FB/FM 6050 or
35 mm SeaRox FB/FM 6040 over the stiffeners

3 mm steel pin
with washer

Fire side



Subject: A-60 Steel Deck:
Plate: SeaRox FB/FM 6020 or SeaRox FB/FM 6040
Stiffener: SeaRox FB/FM 6050 or SeaRox FB/FM 6040



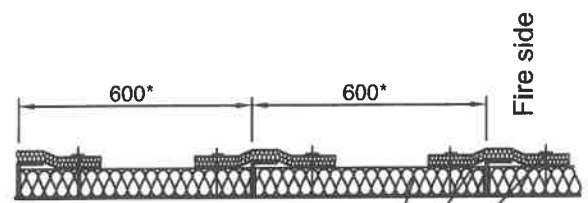
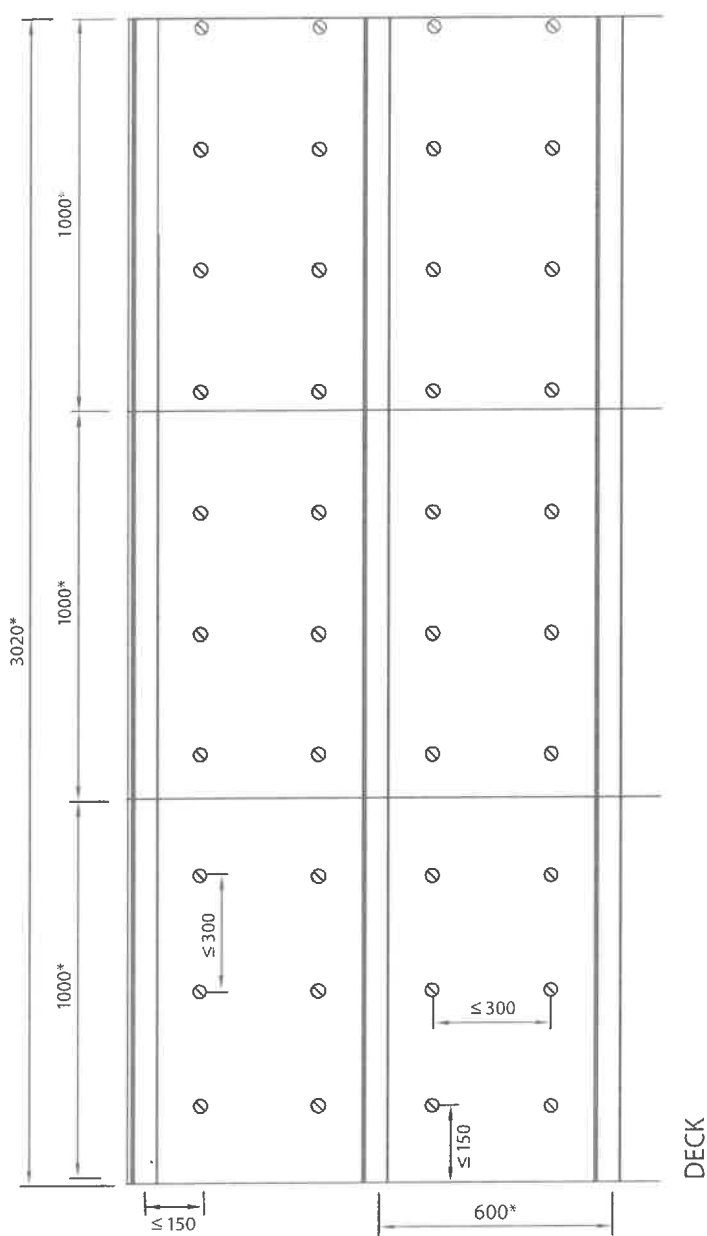

50 mm SeaRox FM 6040 between stiffeners and
 30 mm SeaRox FB/FM 6050 or
 35 mm SeaRox FB/FM 6040 over the stiffeners

3 mm steel pin
 with washer

Fire side

* Dimensions may vary depending on structural design and size of insulation material. All measurements in mm



TECHNICAL INSULATION



Subject: A-60 Steel Deck:
Plate: SeaRox FM 6040
Stiffener: SeaRox FB/FM 6050 or SeaRox FB/FM 6040

Date: 2023/08/10 Designer: DG Drawing No. 800-2

TOP VIEW

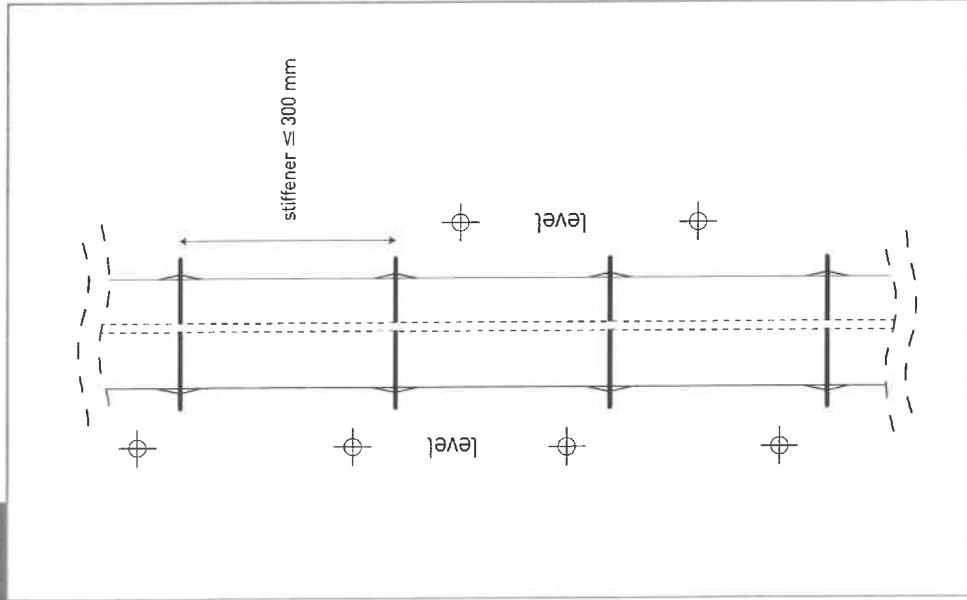

SECTION A

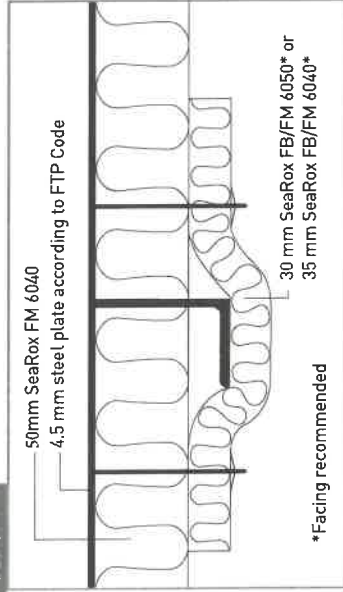

SECTION B

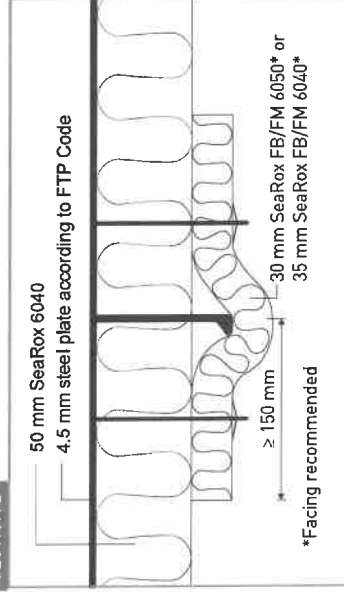

SECTION C

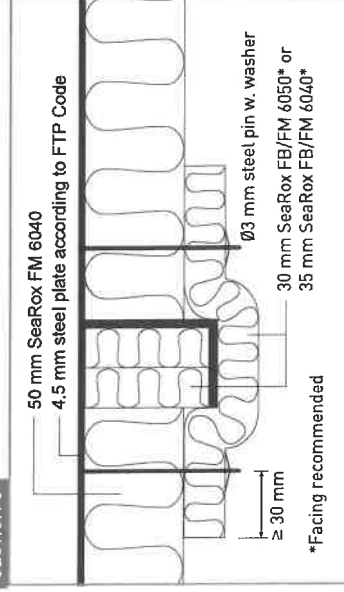

SECTION D

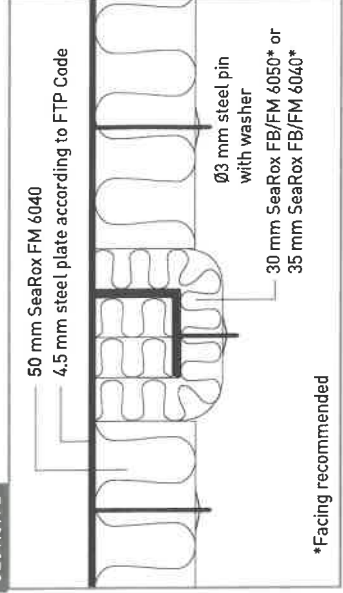

SECTION E

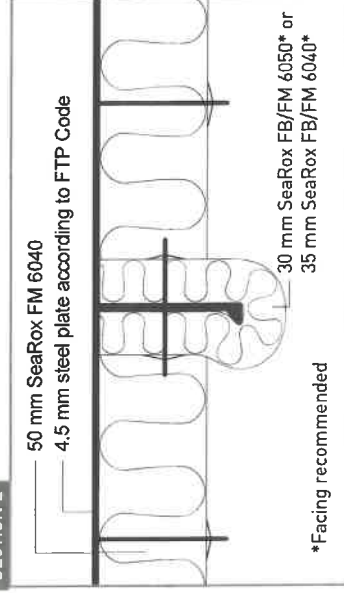

SECTION F

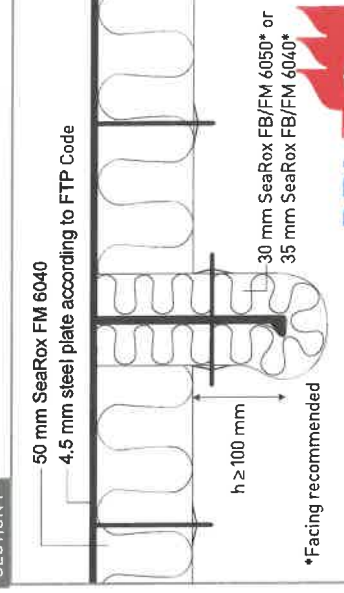

Handwritten signature

Subject: A-60 Steel Deck:
Plate: SeaRox FM 6040
Stiffener: SeaRox FB/FM 6050 or SeaRox FB/FM 6040

Date: 2023/08/10

Designer: DG

Drawing No. 800-3



TECHNICAL INSULATION

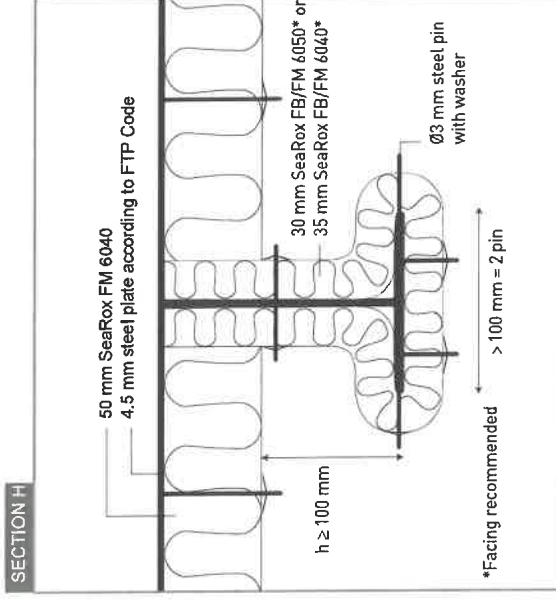
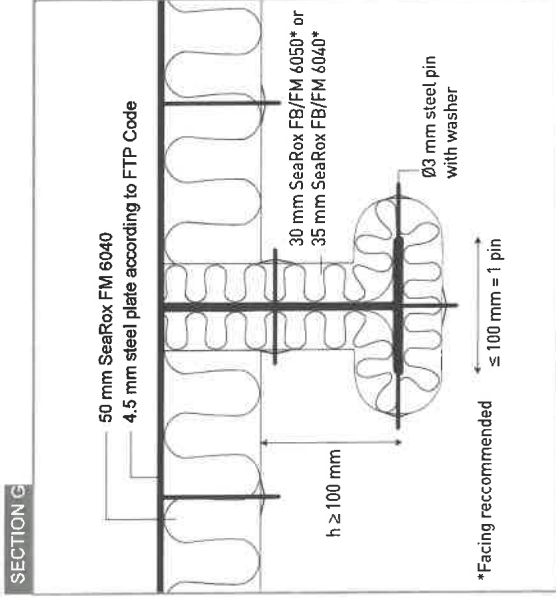
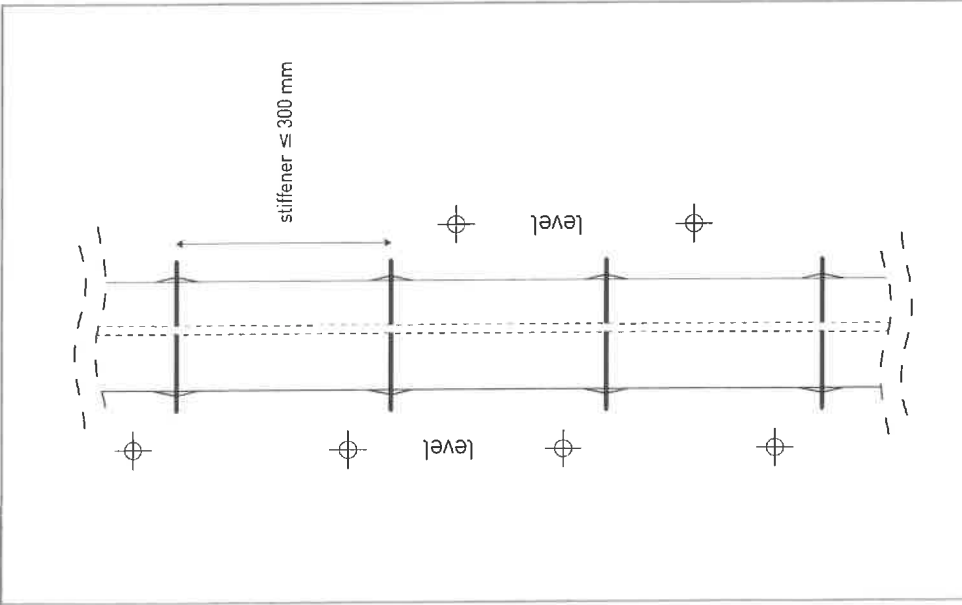

Subject: A-60 Steel Deck:
Plate: SeaRox FM 6040
Stiffener: SeaRox FB/FM 6050 or SeaRox FB/FM 6040



Handwritten signature